

1236R, 1248, 1248R, 1580, 1580R

Multi Purpose, High-speed Centrifuges

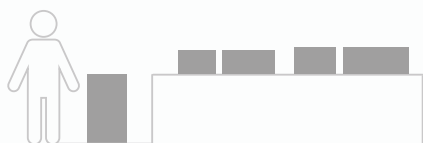

- -
 -
 -
 -
 -
 - Bio**
 -
 -
- R model 1248 / 1580

Features

- High RPM Centrifuges for 2.0 mL up to 85 mL tubes; (2.0 up to 250 mL for 1580R)
- Fast cool function, Pre-cooling to 4°C for temperature-sensitive samples. (R models)
- Bio-Safe buckets ensure safe centrifugation of hazardous samples.
- Intuitive touch control pad with numeric input for easy setting and editing of run parameters.
- 1248 / 1248R / 1236R (Air ventilated/ Refrigerated / Floor standing, refrigerated) models for 48 x bloodtubes, 36 x 15 mL, and 12 x 50 mL tube capacity.
- 1580 / 1580R (Air ventilated / Refrigerated) models for 80 x bloodtubes, 64 x 15 mL, and 20 x 50 mL tube capacity.

Technical Specifications

	1248	1248R Floor standing model 1236R	1580	1580R
Max. RPM/PCF for Fixed Angle	12,000 rpm / 16,582 xg	12,000 rpm / 16,582 xg	15,000 rpm / 24,249 xg	15,000 rpm / 25,910 xg
Max. RPM/PCF for Swing-out	5,000 rpm / 5,394 xg	5,000 rpm / 5,394 xg	5,000 rpm / 5,394 xg	5,000 rpm / 5,394 xg
Max. Capacity for Fixed Angle	6 x 85 mL, 30 x 1.5/2.0 mL	6 x 85 mL, 30 x 1.5/2.0 mL	6 x 85 mL, 30 x 1.5/2.0 mL	6 x (250 & 15) mL, 30 x 1.5/2.0 mL
Max. Capacity for Swing-out	4 x 250 mL, 48 x 15 mL, 4 x 4 MTPs	4 x 250 mL, 48 x 15 mL, 4 x 4 MTPs	4 x 750 mL, 80 x 15 mL, 4 x 4 MTPs	4 x 750 mL, 80 x 15 mL, 4 x 4 MTPs
Temp. Range (°C)	-	-20°C to 40°C	-	-20°C to 40°C
Fast Cool Button	-	Yes	-	Yes
Time Control	Pulse, timed <100 min or continuous	Pulse, timed <10 min or continuous	Pulse, timed <100 min or continuous	Pulse, timed <10 hr or continuous
Time Counting Range	Selectable, at set speed or from starting			
RCF/RPM Conversion	Yes			
Noise Level (dependent on rotor)	≤60 dB			
ACC/DEC Ramps	9/10			
Program Memory	100			
Power Supply	AC 230V, 50Hz (AC 220-230V, 60/50Hz; 110V optional)			
Power Requirement	900 VA	2.5 kVA	1.5 kVA	2.5 kVA
Dimension (W x D x H)	475 x 561 x 330 mm	655 x 620 x 357 mm	540 x 650 x 380 mm	770 x 650 x 390 mm
Net Weight	40 kg	78 kg	57 kg	93 kg
CE MARK	Yes			
Cat No.	GZ-1248	GZ-1248R	GZ-1580	GZ-1580R

Fixed Angle Rotor, GRF-G-250-6

- Capacity : 6 x 250 mL + 6 x 15 mL
- Max. RPM : 8,000
- Max. RCF : 9,588 xg
- Only for 1580R



Tube type (mL)	Max. capacity per rotor	Max. RCF (xg)	Adaptor Cat. No.
100	6	8,586	GAS-100(250)
85	6	8,443	GAS-85(250)
50 conical (Skirt)	6	8,622	GAS-sc50(250)
50 conical	6	8,193	GAS-c50(250)
50	12	8,264	GAM-50-2(250)
30	18	9,159	GAM-30-3(250)
25 conical	6	8,228	GAS-c25(250)
15 conical	24	9,051	GAM-c15-4 (250)
15	24	9,230	GAM-15-4(250)
Φ16 x 100 mm VT	42	9,373	GAM-10-7(250)
Φ13 x 75 ~ 100 mm VT	48	9,373	GAM-7-8(250)
5	16	9,051	GAM-c5-4(250)
1.5 / 2.0	54	9,230	GAM-m2.0-9(250)

Fixed Angle Rotor, GRF-G-85-6

- Capacity : 6 x 85 mL
- 1248 / 1248R / 1236R / 1580 : Max. RPM / RCF : 10,000 / 12,298 xg
- 1580R : Max. RPM / RCF : 12,000 / 17,709 xg



Tube type (mL)	Max. RCF (xg)		Adaptor Cat. No.
	1248 / 1248R / 1236R / 1580	1580R	
50 conical	11,404	16,421	GAS-c50(85)
50	11,627	16,743	GAS-50(85)
30	11,460	16,502	GAS-30(85)
25 conical	9,727	14,006	GAS-c25(85)
15 conical	11,292	16,260	GAS-c15(85)
15	11,515	16,582	GAS-15(85)

Fixed Angle Rotor, GRF-G-50-8

- Capacity : 8 x 50 mL
- 1248 / 1248R / 1236R / 1580 : Max. RPM / RCF : 12,000 / 16,582 xg
- 1580R : Max. RPM / RCF : 15,000 / 25,910 xg



Tube type (mL)	Max. RCF (xg)		Adaptor Cat. No.
	1248 / 1248R / 1236R / 1580	1580R	
30	15,520	24,249	GAS-30(50)
25 conical	13,040	20,376	GAS-c25(50)
15 conical	15,455	24,149	GAS-c15(50)
15	15,053	23,520	GAS-15(50)

Fixed Angle Rotor, GRF-G-c50-8

- **Capacity : 8 x 50 mL Conical**
- 1248 / 1248R / 1236R / 1580 : Max. RPM / RCF : 10,000 / 12,298 xg
- 1580R : Max. RPM / RCF : 13,000 / 20,784 xg



Tube type (mL)	Max. RCF (xg)		Adaptor Cat. No.
	1248 / 1248R / 1236R / 1580	1580R	
50	11,996	20,273	GAS-50(c50)
30	11,896	20,103	GAS-30(c50)
25 conical	10,520	17,779	GAS-c25(c50)
15 conical	11,761	19,877	GAS-c15(c50)

Fixed Angle Rotor, GRF-G-c15-12

- **Capacity : 12 x 15 mL Conical**
- 1248 / 1248R / 1236R / 1580 : Max. RPM / RCF : 12,000 / 16,582 xg
- 1580R : Max. RPM / RCF : 15,000 / 25,910 xg



Tube type (mL)	Max. RCF (xg)		Adaptor Cat. No.
	1248 / 1248R / 1236R / 1580	1580R	
5	12,203	19,067	GAS-c5(c15)

Fixed Angle Rotor, GRF-G-m2.0-30

- **Capacity : 30 x 1.5/2.0 mL**
- 1248 / 1248R / 1236R : Max. RPM / RCF: 12,000 / 15,520 xg
- 1580 / 1580R : Max. RPM / RCF : 15,000 / 24,249 xg



Tube type (mL)	Max. RCF (xg)		Adaptor Cat. No.
	1248 / 1248R / 1236R	1580 / 1580R	
0.5	13,835	21,633	GAS-m0.5(2)
0.2	12,718	19,872	GAS-m0.2(2)

Fixed Angle Rotor, GRA-G-15-24

- **Capacity : 24 x 15 mL**
- Max. RPM : 4,000
- Max. RCF : 3,134 xg



Tube type (mL)	Max. RCF (xg)	Adaptor Cat. No.
14	2,882	GAS-14(f15)
5	2,503	GAS-c5(f15)
Φ13 x 100 mm VT	2,990	GAS-5(f15)
Φ13 x 75 mm VT	2,776	GAS-3(f15)

Swing Rotor, GRS-G-r750-4

- Capacity : 4 Buckets
- Max. RPM : 3,600
- Max. RCF : 2,898 xg
- Only for 1580 / 1580R

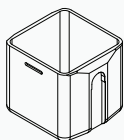

750 mL Rectangular Bucket
GLB-r750-r750

Max. RPM : 3,600
Max. RCF : 2,898 xg
Hole bottom type : Flat

Tube type (mL)	Max. capacity per rotor	Max. RCF (xg)	Adaptor Cat. No.
500	4	2,847	GAS-500(r750)
500 conical	4	2,883	GAS-c500(r750)
250 conical	4	2,883	GAS-c250(r750)
250	4	2,840	GAS-250(r750)
50 conical	20	3,869	GAM-c50-5(r750)
25 conical	20	2,869	GAM-c50-5(r750)
50	32	2,854	GAM-50-8(r750)
15 conical	64	2,869	GAM-c15-16(r750)
5	64	2,869	GAM-c15-16(r750)
15	80	2,854	GAM-15-20(r750)
Φ16 x 100 mm VT	80	2,854	GAM-15-20(r750)
14	32	2,854	GAM-15-20(r750)
Φ13 x 100 mm VT	120	2,854	GAM-5-30(r750)
Φ13 x 75 mm VT	120	2,854	GAM-5-30(r750)

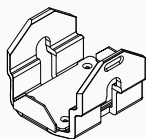

Microplate Holder Bucket
GLP-mw-r750

Max. capacity per rotor: 16 x MTP / 4 x DWP
Max. Load : 330g
Max. RPM : 3,000
Max. RCF : 1,726 xg

Swing Rotor, GRS-G-750-4

- Capacity : 4 Buckets
- Max. RPM : 4,000
- Max. RCF : 3,667 xg
- Only for 1580 / 1580R

Bio-Safe

Manufacturer Validated

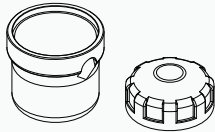
	Tube type (mL)	Max. capacity per rotor	Max. RCF (xg)	Adaptor Cat. No.
 <p>750 mL Bio-Safe Round Bucket GLBB-b750-750</p> <p>Max. RPM : 4,000 Max. RCF : 3,667 xg Hole bottom type : Flat</p>	750 *	4	3,667	-
	500 *	4	3,604	GAS-500(750)
	500 conical *	4	3,667	GAS-c500(750)
	250 conical *	4	3,667	GAS-c250(750)
	250	4	3,595	GAS-250(750)
	50 conical	20	3,667	GAM-c50-5(750)
	50	28	3,595	GAM-50-7(750)
	15 conical	56	3,667	GAM-c15-14(750)
	5	40	3,667	GAM-c15-14(750)
	15	76	3,595	GAM-15-19(750)
	14	28	3,595	GAM-15-19(750)
	Φ16 x 100 mm VT	84	3,595	GAM-10-21(750)
	Φ13 x 100 mm VT	96	3,595	GAM-5-24(750)
	Φ13 x 75 mm VT	96	3,595	GAM-5-24(750)

* Cannot use cap sealing

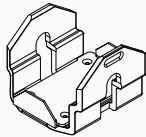

Microplate Holder Bucket
GLP-mw-750

Max. capacity per rotor: 16 x MTP / 4 x DWP
Max. Load : 330g
Max. RPM : 3,000
Max. RCF : 1,726 xg

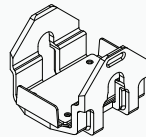

Microplate Holder Bucket
GLP-mw-750D

Max. capacity per rotor: 16 x MTP / 4 x DWP
Max. Load : 330g
Max. RPM : 4,000
Max. RCF : 3,068 xg

Swing Rotor, GRS-G-r250-4

- Capacity : 4 Buckets
- Max. RPM : 4,000
- Max. RCF : 3,134 xg

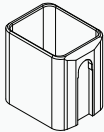

	Tube type (mL)	Max. capacity per rotor	Max. RCF (xg)	Adaptor Cat. No.
 <p>250 mL Rectangular Bucket GLB-r250-r250</p> <p>Max. RPM : 4,000 Max. RCF : 3,134 xg Hole bottom type : Flat</p>	250	4	3,080	GAS-250(r250)
	85 + 15	8+8	3,071	GAM-85-2(r250)
	50 conical (Skirt)	16	3,145	GAM-sc50-4(r250)
	50 conical	12	3,107	GAM-c50-3(r250)
	25 conical	12	3,107	GAM-c50-3(r250)
	50	16	3,095	GAM-50-4(r250)
	15 conical	36	3,107	GAM-c15-9(r250)
	15	48	3,095	GAM-15-12(r250)
	Φ16 x 100 mm VT	48	3,095	GAM-15-12(r250)
	14	24	3,095	GAM-15-12(r250)
	Φ13 x 100 mm VT	48	3,095	GAM-5-12(r250)
Φ13 x 75 mm VT	48	3,095	GAM-5-12(r250)	
1.5 / 2.0	80	3,045	GAM-m2.0-20(r250)	

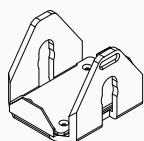

Microplate Holder Bucket
GLP-mw-r250

Max. capacity per rotor: 16 x MTP / 4 x DWP
Max. RPM : 4,000
Max. RCF : 2,737 xg
Hole bottom type : Plate

Swing Rotor, GRS-G-250-4

- Capacity : 4 Buckets
- Max. RPM : 5,000
- Max. RCF : 5,394 xg



	Tube type (mL)	Max. capacity per rotor	Max. RCF (xg)	Adaptor Cat. No.
 <p>250 mL Round Bucket GLB-250-250</p> <p>Max. RPM : 5,000 Max. RCF : 5,394 xg Hole bottom type : Flat</p>	250	4	5,394	-
	250 conical	4	5,352	GAS-c250(250)
	100	4	5,255	GAS-100(250)
	85	4	5,255	GAS-85(250)
	50 conical (Skirted)	4	5,255	GAS-sc50(250)
	50 conical	4	5,394	GAS-c50(250)
	50	8	5,255	GAM-50-2(250)
	30	12	5,255	GAM-30-3(250)
	25 conical	4	5,394	GAS-c25(250)
	15 conical	16	5,338	GAM-c15-4 (250)
	15	16	5,311	GAM-15-4(250)
	Φ16 x 100 mm VT	16	5,311	GAM-10-7(250)
	Φ13 x 75 ~ 100 mm VT	32	5,311	GAM-7-8(250)
	5	16	5,338	GAM-c5-4(250)
	1.5 / 2.0	36	5,311	GAM-m2.0-9(250)

Swing Rotor, GRS-G-100-6

- Capacity : 6 Buckets
- Max. RPM : 4,000
- Max. RCF : 3,105 xg



Bio-Safe Porton Down Certified

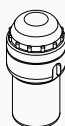

100 mL Bucket
GLBB-b100-100

Max. RPM : 4,000
Max. RCF : 3,105 xg
Hole bottom type : Flat

Tube type (mL)	Max. capacity per rotor	Max. RCF (xg)	Adaptor Cat. No.
100 *	6	3,016	GAS-100(b100)
85	6	3,079	GAS-85(b100)
50 conical (Skirt)	6	2,737	GAS-sc50(b100)
50 conical	6	2,737	GAS-c50(b100)
50	6	2,737	GAS-50(b100)
30	6	3,079	GAS-30(b100)
25 conical	6	3,079	GAS-c25(b100)
15 conical *	18	3,105	GAM-c15-3(100)
15 conical	6	3,105	GAS-c15(b100)
15 *	18	3,052	GAM-15-3(100)
Φ16 x 100 mm VT	30	3,016	GAM-10-5(b100)
Φ13 x 75~100 mm VT	30	3,016	GAM-7-5(b100)
5	18	2,300	GAM-c5-3(b100)
1.5 / 2.0	36	3,016	GAM-m2.0-6(b100)

* Cannot use cap sealing

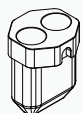

Dual 50 mL Conical Buckt
GLB-dc50-100

Max. RPM : 4,000
Max. RCF : 3,105 xg
Hole bottom type : Conical

Tube type (mL)	Max. capacity per rotor	Max. RCF (xg)	Adaptor Cat. No.
50 conical	12	3,105	-
50	12	2,919	GAS-50(c50)
30	12	2,923	GAS-30(c50)
25 conical	12	2,433	GAS-c25(c50)
15 conical	12	3,105	GAS-c15(c50)

Bio-Safe

Manufacturer Validated

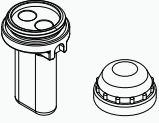
	Tube type (mL)	Max. capacity per rotor	Max. RCF (xg)	Adaptor Cat. No.
 <p>Dual 15 mL Bucket GLBB-bd15-100</p> <p>Max. RPM : 4,000 Max. RCF : 3,032 xg Hole bottom type : Round</p>	15 open top	12	3,032	-

Bio-Safe

Porton Down Certified

	Tube type (mL)	Max. capacity per rotor	Max. RCF (xg)	Adaptor Cat. No.
 <p>Dual 15 mL Conical Bucket GLBB-bdc15-100</p> <p>Max. RPM : 4,000 Max. RCF : 3,105 xg Hole bottom type : Conical</p>	15 conical	12	3,105	-
	14	12	2,799	GAS-14(c15)
	5	12	2,156	GAS-c5(c15)

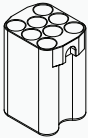
	Tube type (mL)	Max. capacity per rotor	Max. RCF (xg)	Adaptor Cat. No.
 <p>8 x Vacuum tube Bucket GLB-15-8-100</p> <p>Max. RPM : 4,000 Max. RCF : 3,059 xg Hole bottom type : Flat</p>	15	12	3,059	-
	15 open top	48	3,059	-
	Φ16 x 100 mm VT	48	3,059	-
	14	24	2,853	GAS-14(f15)
	5	24	2,343	GAS-c5(f15)
	Φ13 x 100 mm VT	48	3,059	GAS-5(f15)
	Φ13 x 75 mm VT	48	2,576	GAS-3(f15)